

PCB LAYOUT

SPECIFICATIONS

Electrical:

- 1. Rating: 20V, 5.0A
- 1. Dielectric Withstand Voltage: 100V AC
- 2. Contact Resistance: 40 mΩ Max
- 3. Insulation Resistance: 100 MΩ Min

Mechanical:

- 1. Connector Mate and Unmate Force
 - 1.1 Mate force: 5~20 N
 - 1.2 Unmate force: 8~20 N

Material:

- 1. Housing: PA9T
- 2. Contact: C19400
- 3. Shell: SUS

Finish:

- 1. Contact: Plated Gold in Mating Area ;
Gold Plated on Solder Balls ;
Nickel under plated overall
- 2. Shell: Nickel under Plated surface layer

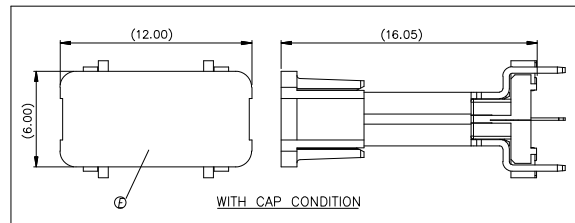
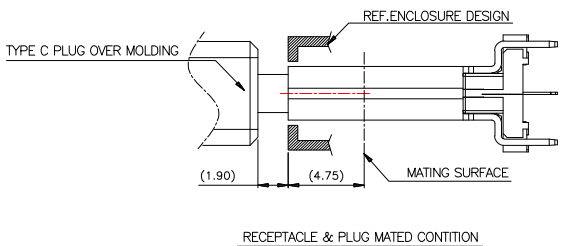
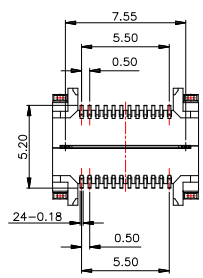
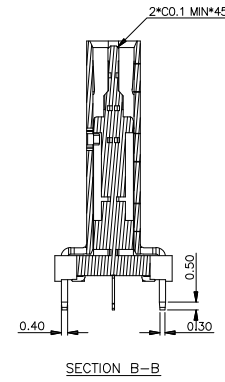
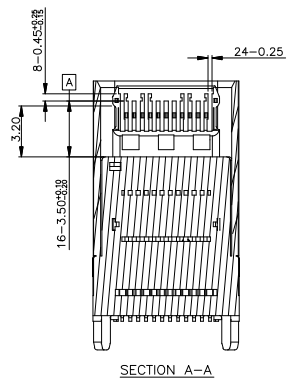
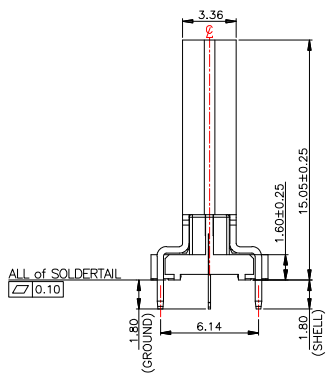
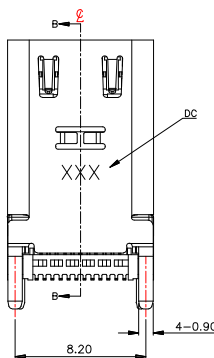

CONTACT 建倚科技股份有限公司
CONTACT TECHNOLOGY CORP.

TOLERANCE UNLESS OTHERWISE STATED:
 Up to 5 ±0.2
 Above 5 ~ 15 ±0.3
 Above 15 ~ 30 ±0.4
 Above 30 ~ 50 ±0.5
 Angle ±0.3°

3RD. ANGEL'S

UNITS MM

DRAWN BY:	DATE	MAT'L	TITLE	CONNECTOR
Jack Lu	01/23/24	FINISH	MODLE	USB 3.1 TYPE C 直立式 SMT L15.0mm 外殼腳長1.8 無定位柱 GEN 3X2 40G
CHECKED BY:	DATE	SCALE	DWG NO.	SBC-240VS11-45-S461
Jacky Chen	01/23/24	1 : 1	PART NO.	SBC-240VS11-45-S461
APPROVED BY:	DATE	SHEET NO.		
Tony Kao	01/23/24	1 of 1		

ITEM NO.	DESCRIPTION	DRAWN	DATE